

# The Claremont

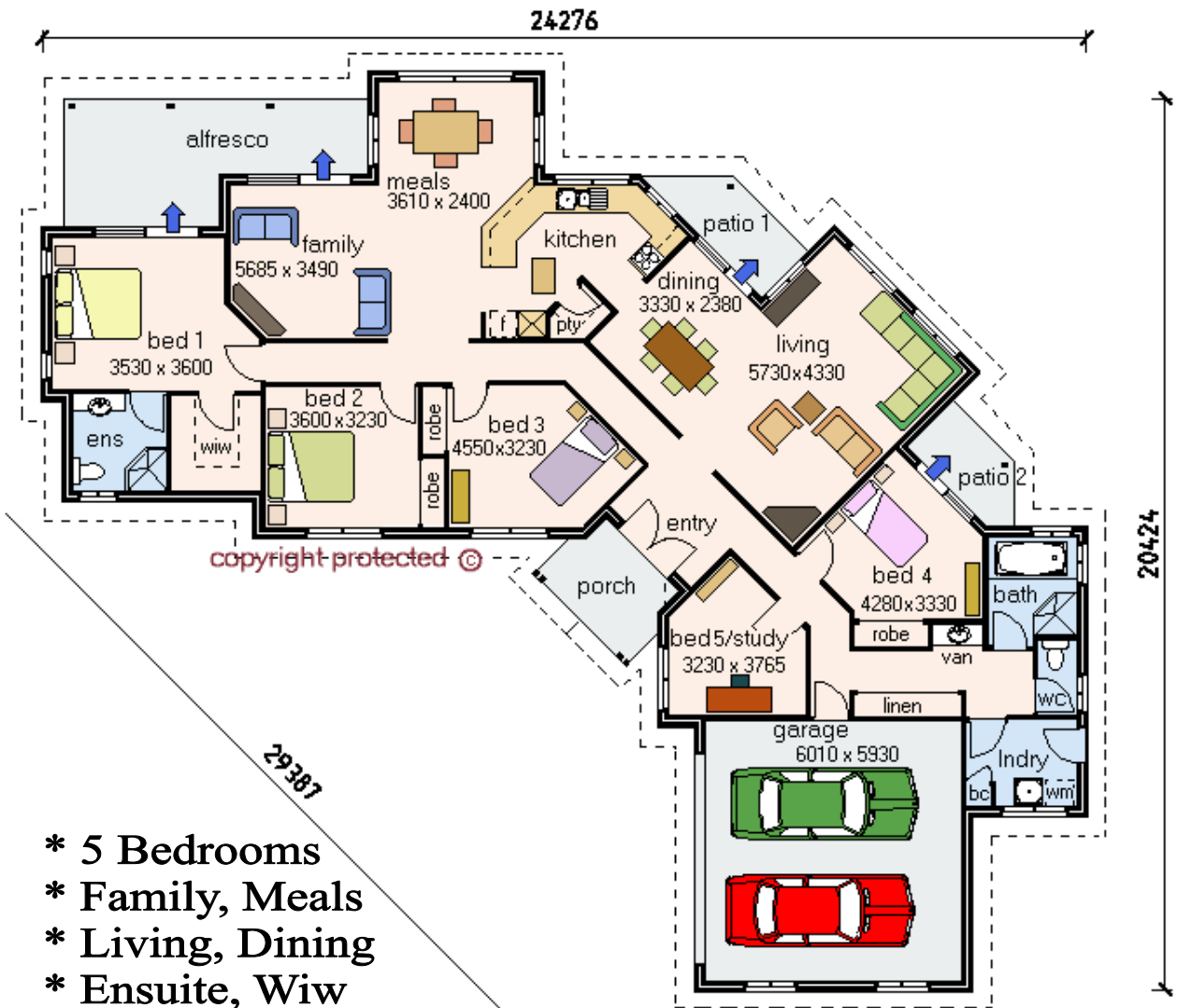

ESTATE COLLECTION



- \* 5 Bedrooms
- \* Family, Meals
- \* Living, Dining
- \* Ensuite, Wiw
- \* 3 way bathroom
- \* Covered Verandah
- \* Double Garage
- \* Area 279.89sqm

c167.dab

[www.craftsmanhomes.com.au](http://www.craftsmanhomes.com.au)



COPYRIGHT: This drawing is the property of Craftsman Homes, reproduction in whole or part is strictly forbidden without the written consent of the Managing Director of Craftsman Homes. Failure to observe will result in Legal Action being taken